

CONSERVATIONIST® POWER VENT

APPROVAL RATINGS AND CERTIFICATION

- All models comply with: ANSI Z21.10.3/CSA 4.3 and current edition of ASHRAE/IES 90.1
- All models are approved for use in combined appliance applications

CFC-FREE FOAM INSULATION

- Minimizes radiant heat loss

DIP TUBE

- Carries inlet water deep into tank

HOT SURFACE IGNITION

- Has a solid state ignition surface that does not flutter or blow out
- Provides increased reliability and efficiency over spark ignition systems, while eliminating the pilot and saving energy

USER-FRIENDLY

- State-of-the-art electronic gas control provides more precise temperature control
- LED control light displays operation status and diagnostics information

ENHANCED-FLOW BRASS DRAIN VALVE

- Solid brass, tamper resistant, enhanced-flow, ball type, drain valve
- Uses a standard female hose fitting that allows for fast and easy draining during maintenance
- Designed for easy operation, this valve includes an integral screwdriver slot that features a ¼ turn (open/close) radius, which not only permits full straight-through water flow but also a quick and positive shut off

Blue Diamond® GLASS COATING

- Provides superior corrosion resistance compared to the industry-standard glass lining

STANDARDS

- Design-certified by CSA International, according to ANSI Z21.10.3 - CSA 4.3 standards governing storage-type water heaters
- Meets the thermal efficiency and standby loss requirements of NRCan and current edition of ASHRAE/IESNA 90.1

POWERED VENTING

- Provides more venting flexibility and savings with a new quiet blower that allows for exhaust venting through the roof or sidewall with plastic pipe such as ULC S636 PVC, CPVC, and polypropylene
- Up to 125 equivalent feet of pipe make installation easy in any situation
- BTF-80 is a Category 3 (positive pressure non-condensing) appliance

ANODES

- Tank-mounted, screw-in magnesium anodes for longer tank life

HIGH INPUT

- 76,000 BTU input assures plenty of hot water is available by providing faster recovery rates and higher first hour draws

BURNER

- High input, multi-port burner for improved combustion efficiency

BUILT-IN CONDENSATE FITTING

- A condensate management coupling that attaches vent pipe to the blower is included

INSTALLED TEMPERATURE & PRESSURE RELIEF VALVE

- Factory-installed and matched to the heater. (Specify if your local code requires a special T&P)

MAXIMUM HYDROSTATIC WORKING PRESSURE 150 PSI

WARRANTY

- 3 year limited tank warranty
- 1 year limited parts warranty

For complete warranty information, consult written warranty or contact A. O. Smith



**BTF-80
SERIES 210/211**



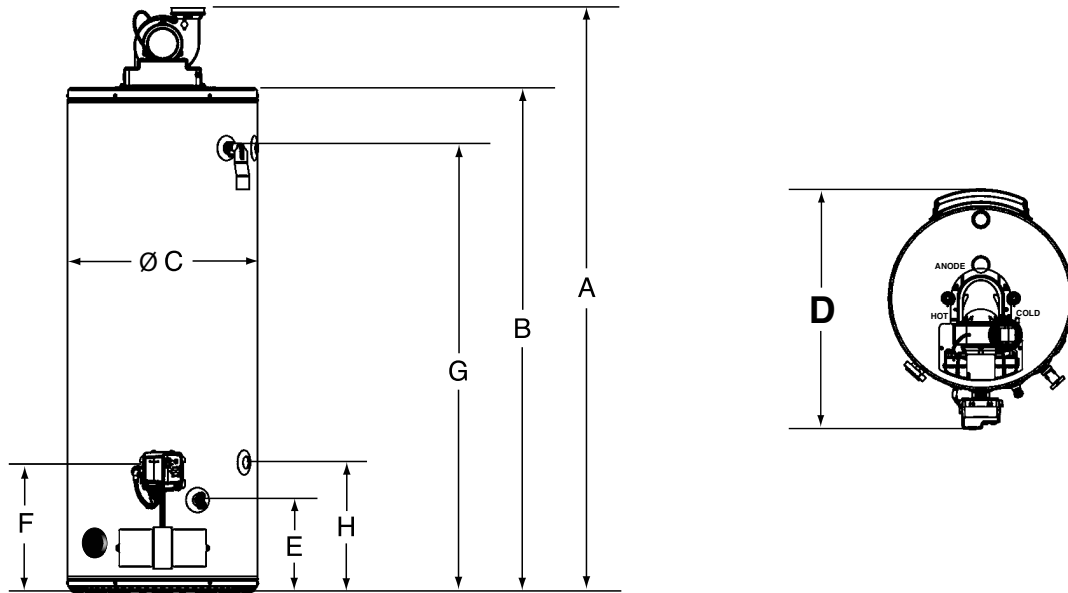

DIMENSIONS

MODEL NUMBER	A IN (CM)	B IN (CM)	C IN (CM)	D IN (CM)	E IN (CM)	F IN (CM)	G IN (CM)	H IN (CM)	Water Connections	Gas Connection	Approx. Shipping Weight LB (KG)
BTF-80	70 5/8 (179)	61 1/4 (156)	26 (66)	33 1/8 (84)	11 (28)	13 1/4 (36)	53 (135)	15 1/4 (39)	3/4" NPT	1/2" NPT	277 (126)

Dimensions and specifications subject to change without notice in accordance with our policy of continuous product improvement.

RECOVERY CAPACITIES

U.S. GALLONS/h AND LITRES/h AT TEMPERATURE RISE INDICATED

MODEL NUMBER	INPUT		APPROX. CAPACITY		°F	30°F	40°F	50°F	60°F	70°F	80°F	90°F	100°F	110°F	120°F	130°F	140°F
	BTU/h	kW	USG	L	°C	17°C	22°C	28°C	33°C	39°C	44°C	50°C	56°C	61°C	67°C	72°C	78°C
BTF-80	76,000	22.3	75	280	GPH	246	185	148	123	106	92	82	74	67	62	57	52
					LPH	932	699	559	466	400	350	311	280	254	233	215	200

Available in LP (Propane) gas

Can be installed up to 10,100 feet (3,078 m) without alteration.

SAMPLE SPECIFICATION

Water Heater(s) shall be power vent model no. _____ as manufactured by A. O. Smith or an approved equal. Heater(s) shall be internally glass-lined and gas-fired, equipped to burn _____ gas, and design-certified to the latest ANSI Standard by CSA International. Rating of _____ Gallons and an input rating of _____ BTU/h with a recovery capacity of _____ GPH at 100°F. Water heaters must be certified for power venting applications using standard schedule 40 ULC 636 PVC, CPVC or polypropylene vent piping. The water heater shall include a 6' plug-in cord and provision for direct connection to standard electrical conduit. Blower shall include a pressure switch which will shut down power to the burner in case of vent system failure due to down drafts or vent blockage. Heater shall have a maximum working a pressure of 150 psi, and a nominal storage tank capacity of _____ gallons with a 3/4" relief valve opening. Heater(s) shall also be equipped with an automatic shut off device to shut off entire gas supply in event of excessive temperature in tank. Outer jacket shall have a baked enamel finish.